

TA-SCOPE Relay

Example 1

Example 2

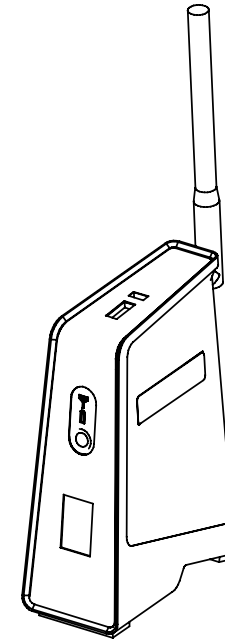
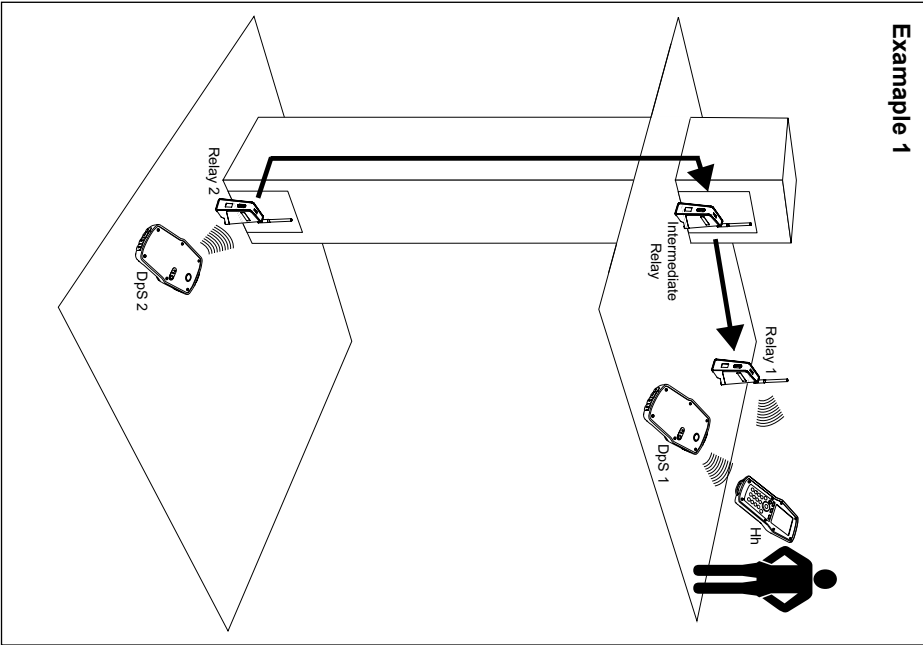
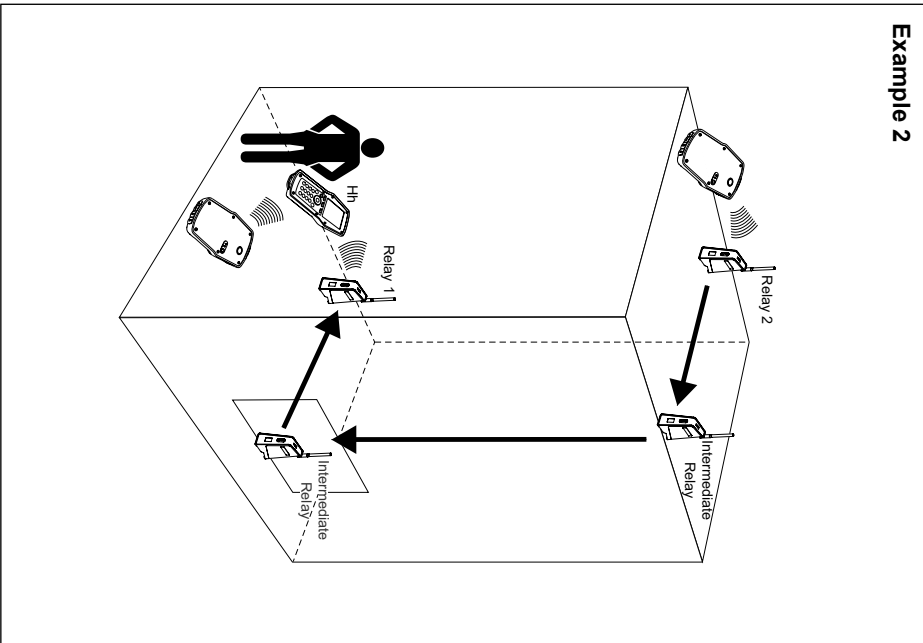
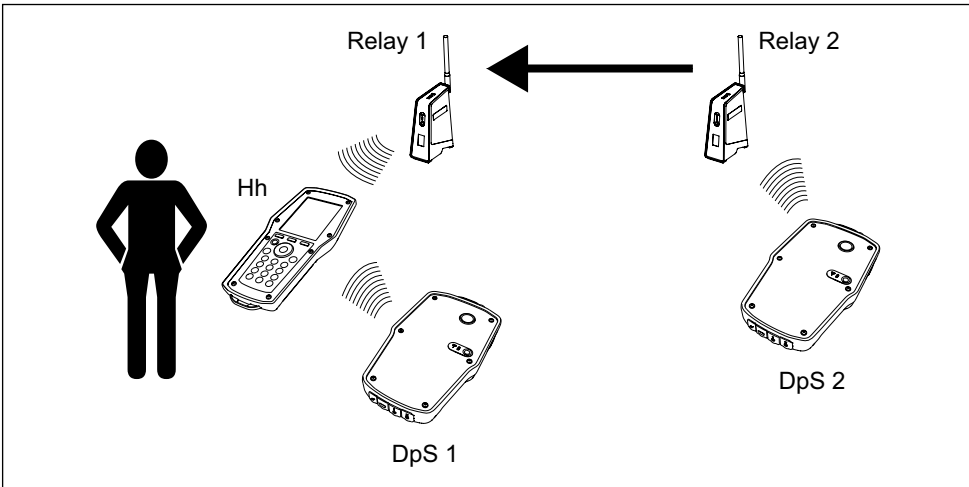
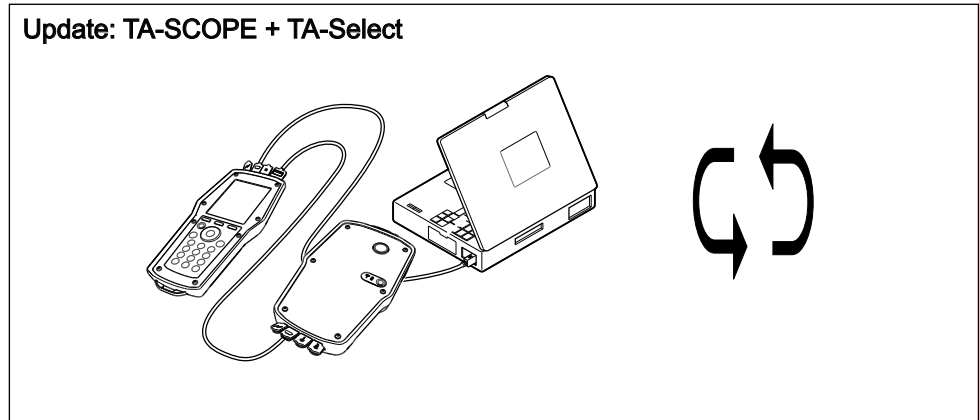
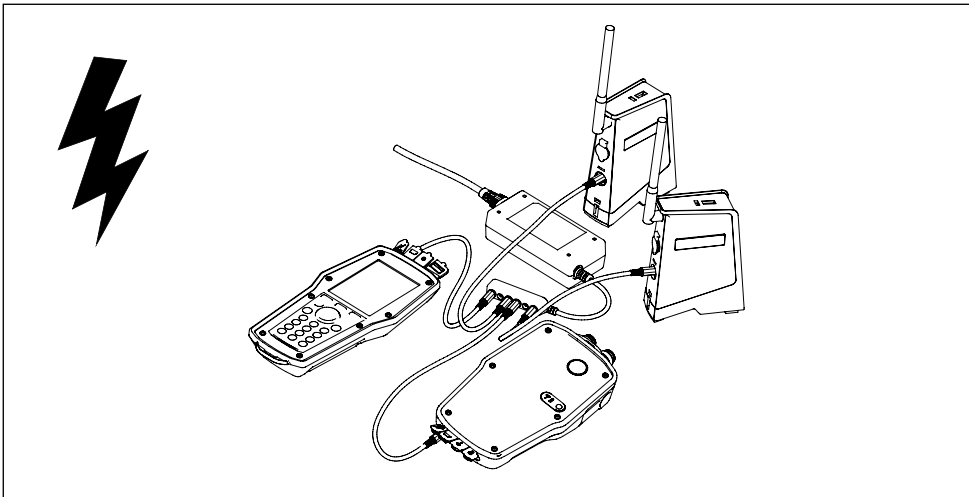

www.tahydrionics.com/en/RelayFAQ

The US:
 « THIS DEVICE COMPLIES WITH PART 15 OF THE FCC RULES. OPERATION IS SUBJECT TO THE FOLLOWING TWO CONDITIONS: (1) THIS DEVICE MAY NOT CAUSE HARMFUL INTERFERENCE, AND (2) THIS DEVICE MUST ACCEPT ANY INTERFERENCE RECEIVED, INCLUDING INTERFERENCE THAT MAY CAUSE UNDESIRE OPERATION.
 NOTE: THE GRANTEE IS NOT RESPONSIBLE FOR ANY CHANGES OR MODIFICATIONS NOT EXPRESSLY APPROVED BY THE PARTY RESPONSIBLE FOR COMPLIANCE. SUCH MODIFICATIONS COULD VOID THE USER'S AUTHORITY TO OPERATE THE EQUIPMENT.
 The antenna(s) used for this transmitter must be installed to provide a separation distance of at least 20 cm from all persons.

1. Home screen with 'Settings' icon highlighted.

2. Settings menu with 'Configure relays' selected.

3. Relay configuration screen with a list of options: 1. Wireless signal, 2. Configure relays, 3. Technical parameters, 4. Units, 5. Power saving, 6. Device names, 7. Language & formats, 8. Key beep, 9. Date & time, 10. Information messages, 11. Software updates.

4. Relay configuration screen with a message: 'You will now start configuring Dp sensors and Relays for long-distance transmission.'

5. Relay configuration screen showing a table of relay settings:

MAC	Name	Radio
XXXXXX XXXX		Enabled
XXXXXX XXXX		Enabled
XXXXXX	Relay 1 (0#)	Enabled
XXXXXX	Relay 2 (DpS 2)	Enabled

6. Summary screen showing three relay configurations with status icons and MAC addresses (XX VX.X).